



AMERICAN EMERGENCY
VEHICLES



TYPE I F350 / 450 / 550



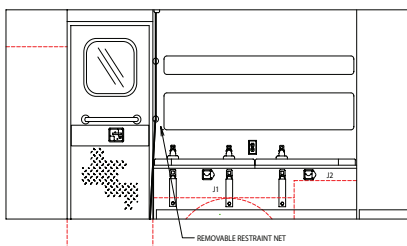
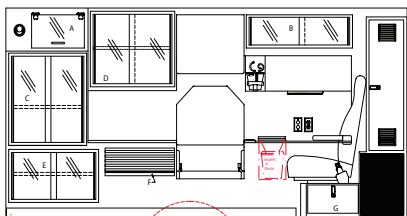
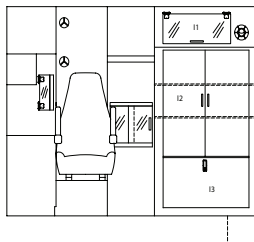
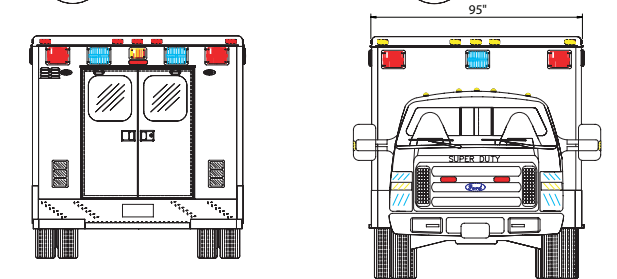
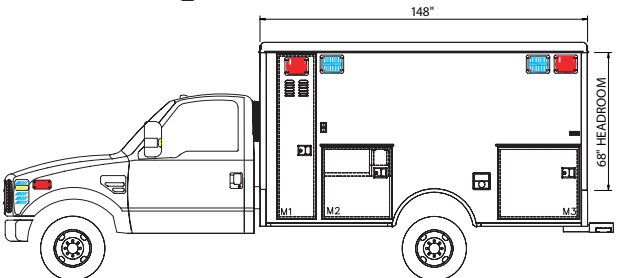
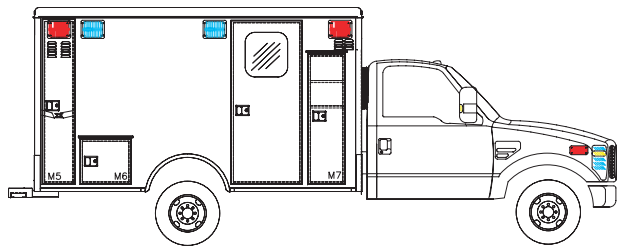

TYPE I F350 / 450 / 550



CHASSIS

- Ford F-Series, Turbo Diesel / High Trim Level / 47A Ambulance Prep Package
- 6.4 Turbo Diesel Engine
- 4R100 Electronic Transmission
- Dual OEM Alternator
- Engine Block Heater
- HVAC Hook Ups Under Body
- Electric Door Locks
- High Trim Level
- Dual Batteries Under Hood

CONVERSION

- | | | | |
|--|--|--|---|
| <p>Conversion*
Module
Attendant Seat
Batteries
Battery Switch
Backboard Storage
Back Up Alarm
Biowaste System
Bumper, Rear
Cabinet, Action Area
Cabinet, Bench Lid
Cabinet, CPR Seat
Cabinet, Electrical
Cabinet, Laminate
Cabinet, Polycarbonate
Cabinet, RF
Cabinet, Tambour Doors
Coax Cables
Compartment, Lining
Compartment, Shelves
Compartment, Straps</p> <p>Console
Cot Mount
Door Hold Opens
DOT Package
Drip Rails
Electrical System
Electrical Wiring
Fasteners, Exterior
Fender Flares
Flooring
Flooring, Roll Up
Fuel Fill
Ground Straps
Handles, Interior
Headliner
Heat-AC</p> | <p>TraumaHawk, High Trim
148" x 95" x 68" Interior Headroom
Captain's Chair on Storage Box
(2) Underhood
Cole Hersee 2484-16
Right Rear Compartment, Vertical
With Auto Reset
Streetside
Treadplate, with Center Flip Up Section
Formed ABS, Fixed in Place
Split Lid
Streetside with Telemetry Area
Behind Attendant Seat
Choice of Optional Colors
Gray Tinted or Clear with Full Handles
Wood Doors with Inside/Outside Access
(1) Total in Patient Area
(1) Tagged at Both Ends
Diamond Plate
(1) Total Aluminum in Exterior Compartment
(1) Total in Right Rear Compartment
for Backboards
Wood Between Cab Seats
Stryker
Grabbers on Rear Doors
Shipped Loose
Bright Finish Aluminum
Printed Circuit Board with LED Diagnostics
Color, Name & Number Coded
AVK for Attachment of Door Panels
Aluminum
Choice of Optional Colors
3" Recessed
Aluminum Housing
(4) with Star Washers
Handicap Style on all Entry Doors
(1) Piece Front to Rear, Gloss White
Ceiling Ducted</p> | <p>Insulation
IV Hooks
KKK Package
License Plate Holder
Lights, Action Area
Lights, Clearance
Lights, Dome
Lights, Handheld Spotlight
Lights, Indicator</p> <p>Lights, Load
Lights, Scene
Lights, Side Marker
Lights, Tail
Lights, Third Brake
Lights, Warning Package
Outlets, 115vac
Outlets, 12vdc
Overhead Grabrail
Oxygen Cylinder Rack
Oxygen Outlets
Paint
Paint Belt
Patient Floor
Reflectors
Shoreline
Siren
Siren Speaker
Skirtrails
Suction System</p> <p>Undercoat
Upholstery
Wheel Covers
Windows, C/S Upper
Windows, Pass Thru
Windows, Rear Upper</p> | <p>Reflectix Circumferential Package
(2) Perko Hooks Installed Overhead
To Present Revision
Recessed in Rear Kickplate
12vdc Fluorescent
LED On Front & Rear
(6) Total, Halogen
400,000CP Blue Eye
Door, Compartment Ajar, & Battery
on Cab Console
(2) Whelen on Rear
(2) Whelen on Each Side
On Sides of Body
Triple Light Cluster on Rear
Mounted over Rear Doors
Whelen Perimeter Lighting
(2) Total (1) Curbside (1) Streetside
(2) Cigar Style Outlets
72" with Rounded Ends, Recessed
Aluminum Rack, LF Compartment
(2) Total , Ohio Style
OEM Polar White
Single Belt
Plywood, Full Length & Width, Insulated
(6) Total, (4) Rear & (2) Front
15 Amp Inlet on Streetside
Whelen WS-295
Dual 100 watt
Diamond Plate
SSCOR with Disposable Container,
Electric Pump
Per QVM Guidelines
Choice of Optional Colors
Stainless Steel
Std. Tint Fixed
Sliding Lexan with Bellows
Std. Tint Fixed</p> |
|--|--|--|---|

*Base conversion shown—additional configurations and options available as part of AEV's ongoing program of product improvement. Specifications are subject to change without notice.



AMERICAN EMERGENCY VEHICLES